

DU-HA Humpstor

Tools Needed:

- | | |
|-------------------------------|-----------------------------|
| // Hex Key Wrench 1/8" | // Wrench or Socket - 3/8" |
| // 2 Open-End Wrenches - 1/2" | // Wrench or Socket - 7/16" |
| // Socket - 1/2" | // Hex Key Wrench 7/32" |

Installation Instructions:

STEP 1 - Attach Handle

Place Handle (B) over holes in Lid Top. Insert two Bolts #10 x 1.5 (M) through Handle (B) and Humpstor (A) Lid. Secure with Flat Washer - #10 (N) and Lock Nut #10 (O) Use 1/8" Hex Key Wrench.

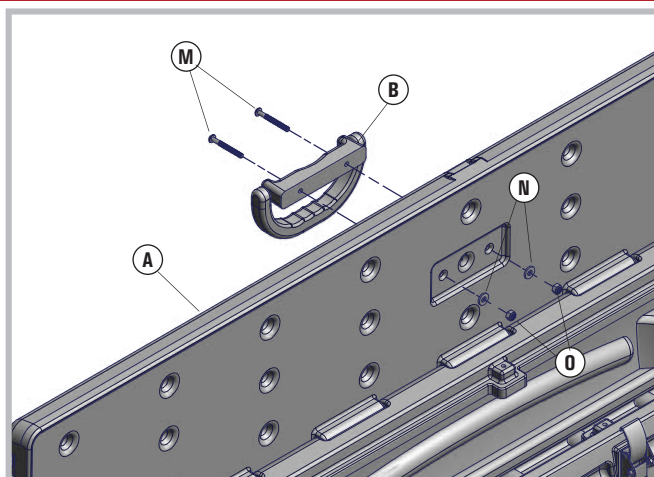

STEP 2 - Assemble Rail Clamps

Assemble Rail Clamp set (G) by sliding A and B parts of the clamps together and insert the Bolt Button Head 3/8" x 1-3/4" (Y) through the bottom slot on part A and thread into threaded hole on part B. Leave clamp loose so you can slide it onto the rail of the truck.

Note: If you are using the optional Toyota / Nissan Installation Kit or the optional Topper Installation Kit no clamp assembly is required.

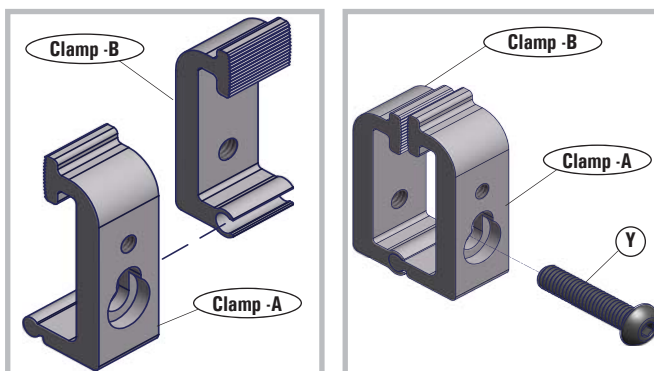

STEP 3 - Attach Stabilizer Foot

Install Stabilizer Foot

Attach one Stabilizer Foot (K) to the Left (E), Right (F) and Center Support (AB) Brackets by threading one Flange Nut - 5/16" (P) onto Stabilizer Foot (K) shaft and insert through the lower hole of each Bracket (E, F and AB). Thread a second Flange Nut (P) onto Stabilizer Foot (K) shaft sandwiching the Bracket in between. Hint: Flanged side of nuts should face Bracket.

Note: Finger tighten.

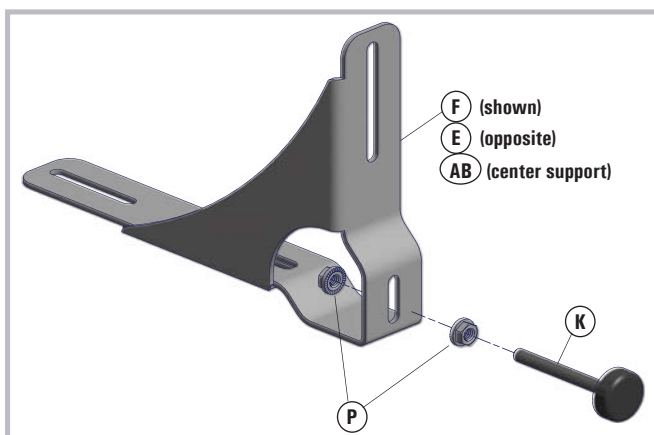

Extended Stabilizer Foot

Some installations require a longer Stabilizer Foot (K) (Toyota Tundra for example). In such cases, prior to installing the Stabilizer Foot (K), attach one Hex bolt - 5/16" x 2" (U) and Coupling Nut - 5/16" (X) to each Stabilizer Foot (K).

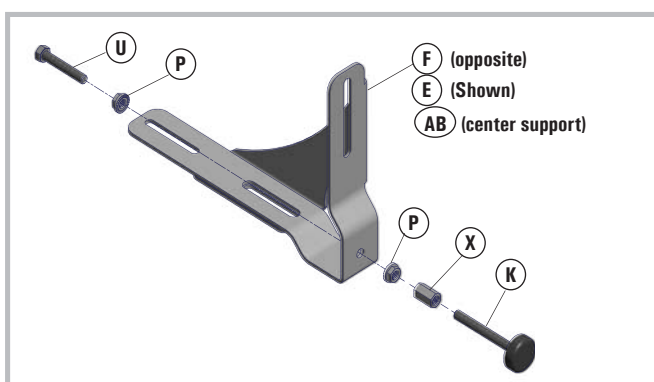

STEP 4 - Assemble Brackets

Option I - Topper or Open Bed Mount

Use this option for most standard installations for open truck beds or for use with toppers. No additional Drop Down Plates (H) or Offset Plates (I) are needed. Use the standard Right (F) / Left (E) and Center Support (AB) Brackets.

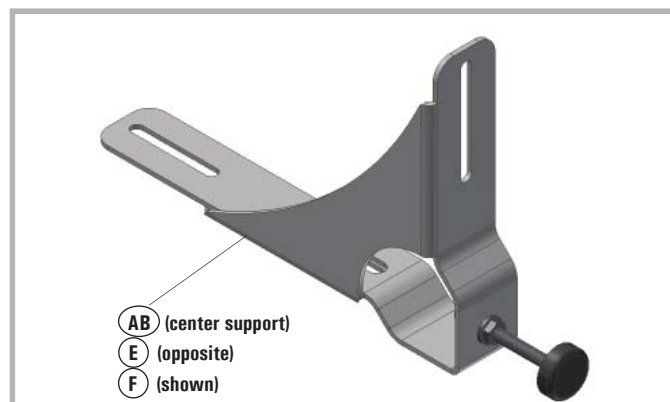

Option II - Roll-up, Fold-up, or Hard Cover

Attach Drop-Down Plate (H) to Right (F) / Left (E) and Center Support (AB) Brackets with two Carriage Bolts - 5/16" x 3/4" (AA), two Flat Washers 5/16" (V) and two Lock Nuts 5/16" (W).

NOTE: Offset Plates (I) may be needed to not interfere with the topper mounting areas.

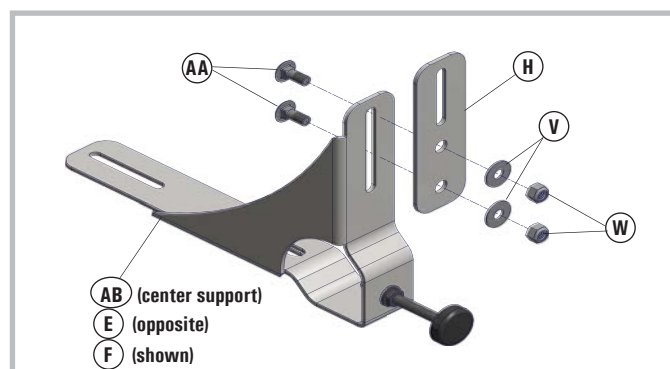

Option III - GM Short Box or other Short Box

In the case of some truck beds, or due to an obstruction, the standard clamp spacing will not work. In such cases, use one or both Offset Plates (I) to move the Clamp Assembly to a suitable location. Attach Offset Plate (I) to Right (F) and/or Left (E) Bracket with two Carriage Bolts - 5/16" x 3/4" (AA), two Flat Washers 5/16" (V) and two Lock Nuts 5/16" (W).

Note: Offset Plates should extend toward the middle of the Humpstor. Offset Plates are not needed on the Center Support Bracket (AB).

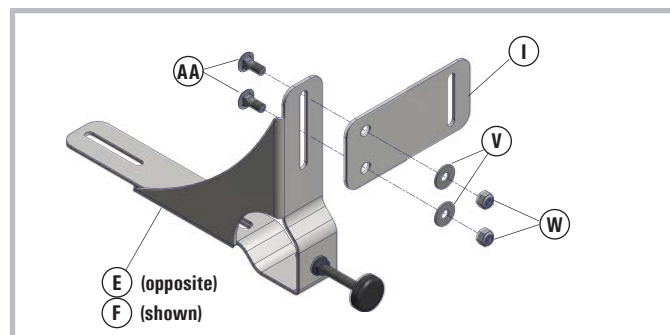

Option IV - GM Short Box with Bed Cover

In some cases both Offset Plates (I) and Drop-Down Plates (H) are required. Connect Offset Plate holes to Left or Right Bracket slots and connect Drop-Down Plate holes to Offset Plate slot.

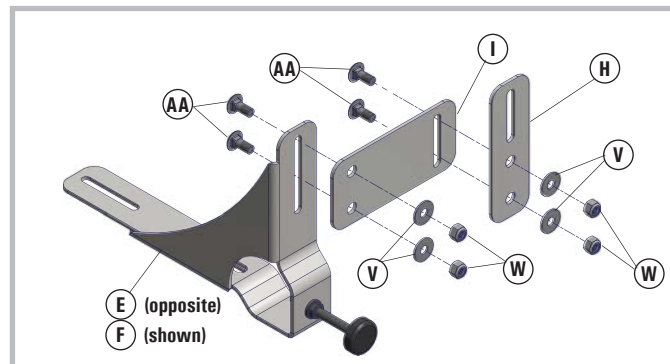

STEP 5 - Attach Rail Clamps to Truck

Look at your bed rail to determine where to attach your rail clamps, find locations where you can attach the clamps at the below spacings and still have room to operate the end latches on the Humpstor. Attach Rail Clamps (G) to truck bed rail by sliding clamps onto truck bed rail from the bottom of the rail, slide onto rail as far as possible. Secure to rail using Bolt Button Head $\frac{3}{8}$ " x $1\frac{3}{4}$ " (Y) (already installed in clamp) tighten firmly with $\frac{7}{32}$ " Hex Key Wrench, make sure to keep clamps vertical and position at desired spacing as listed below (measurements are to the center of the hole in the Rail Clamp):

// 51.75" for Standard Spacing
// 47.75" with one Offset Plate // 43.75" with two Offset Plates

Now attach a clamp that is as close to centered between the two previously installed clamps as possible, this will be for the Center Support Bracket (AB).

Optional Installation Kits: 70250 - Hardware Package for Toyota / Nissan Trucks
70251 - Hardware Package for Trucks with Toppers

STEP 6 - Attach Brackets to Rail Clamps

Attach Left (F), Right (E) and Center Support (AB) Brackets to Rail Clamps (G) using Hex Bolt $\frac{5}{16}$ " x $\frac{3}{4}$ " (O), Flat Washer $\frac{5}{16}$ " (V), Lock Washer $\frac{5}{16}$ " (Z), using one per Rail Clamp set (G), thread into top hole in Rail Clamp, as shown below in view (a). Determine where you want the top of the Humpstor to be positioned and position the brackets (E&F) 10" below that position to the bottom of the brackets (E&F) where the Humpstor sits, as shown below in view (b). Position Center Support Bracket (AB) $\frac{3}{8}$ " lower than Left and Right Brackets.

Level bracket assembly by adjusting each Stabilizer Foot (K) to contact the side of the truck box, try to have Stabilizer Foot contact a flat surface.

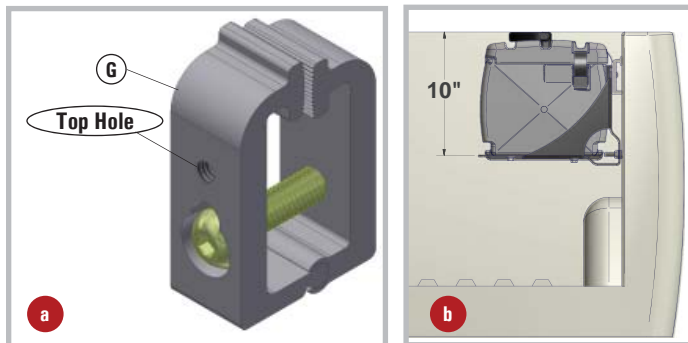

STEP 7 - Attach Humpstor to Brackets

Humpstor Positions

The Humpstor can be mounted with the lid opening toward the inside of the truck bed (a) or with the lid opening toward the outside of the truck bed (b). The assembly steps and hardware are the same other than the orientation of the Humpstor.

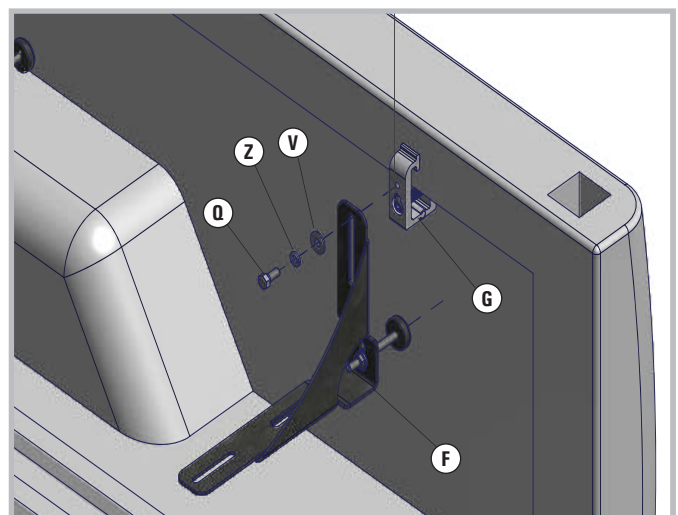
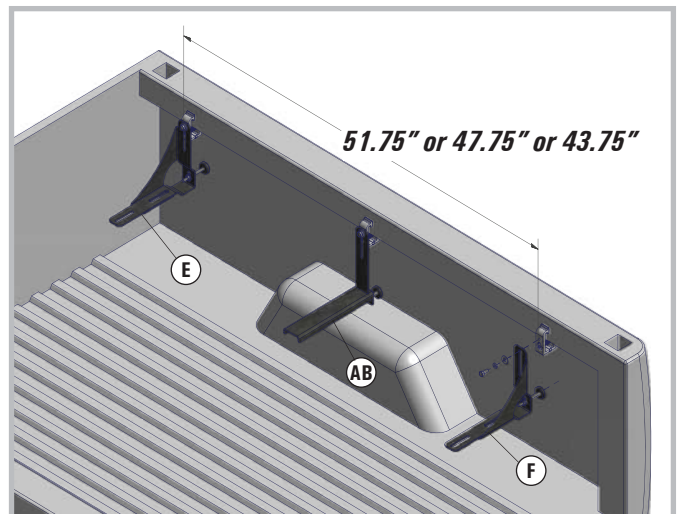
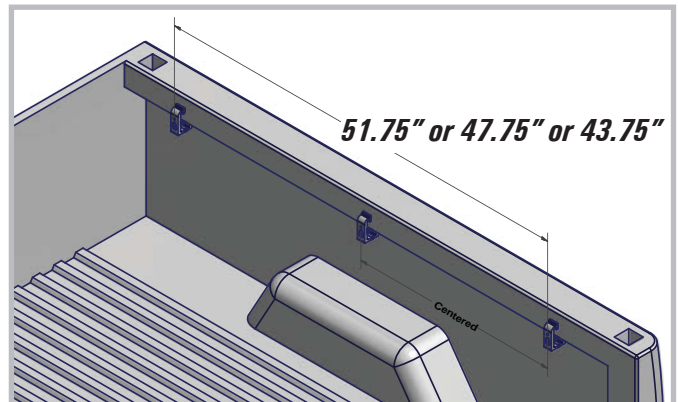
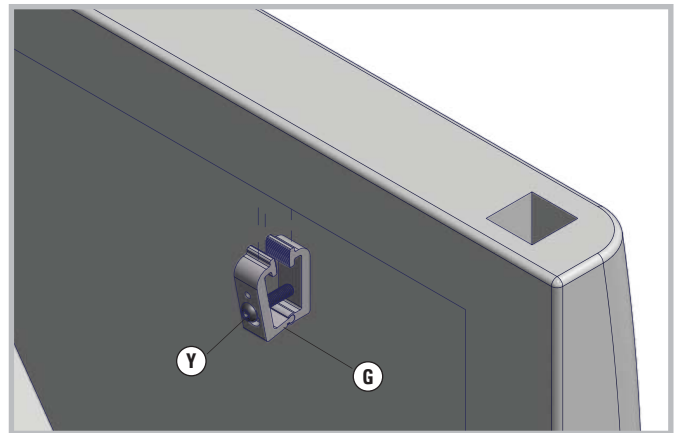
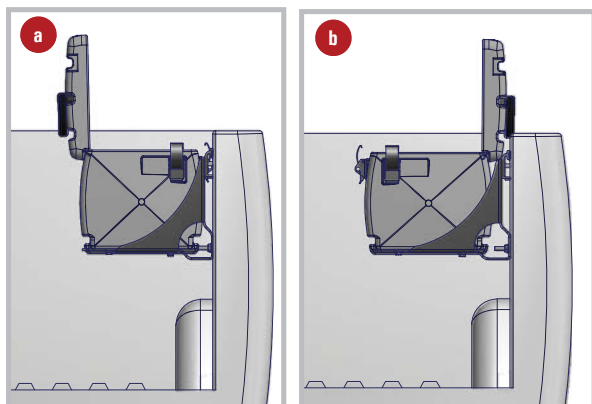

Page 4 - Continued . . .

Humpstor Attachment

Place the Humpstor (A) onto the Left (E) and Right (F) Brackets. Thread one Hex Bolt - 1/4" x 5/8" (R), Lock Washer - 1/4" (T) and Flat Washer 1/4" (S) through bottom slots into the threaded holes in the bottom of the Humpstor (two on each end).

Note: Center Support Bracket (AB) does not get attached to Humpstor, Humpstor should just be set on the bracket for support.

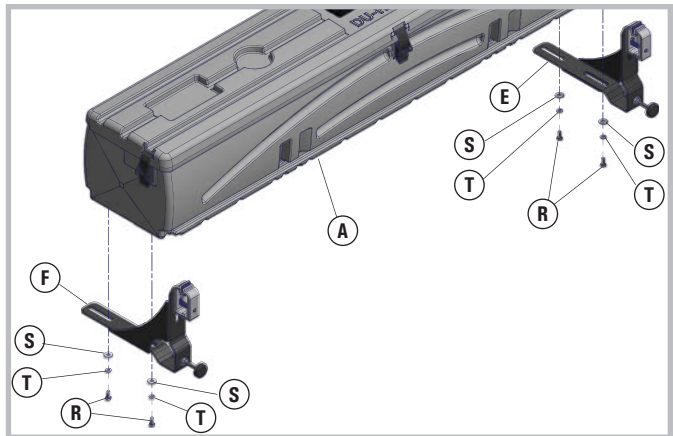

Humpstor Adjustment

Slide Humpstor in or out to desired position. For example, in a roll-up cover the Humpstor should be slid away from the side rail of the truck bed to allow the lid to open; for open-bed, the Humpstor should be as close as possible to the bed rail of the truck.

To adjust the Humpstor vertically loosen the Clamp Bracket hex bolt 5/16" x 3/4" (Q). Slide the Brackets up/down as needed along the slot in the Brackets or Drop-Down Plates. Make sure Humpstor is level, then tighten all hardware connections.

Note: Humpstor should be adjusted as high and as close to the rail as possible while still allowing the lid to open properly.

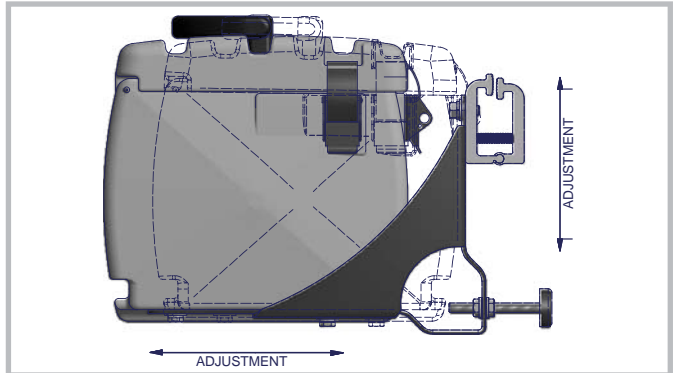

STEP 8 - Install Organizer / Gun Holders

Foam Organizer / Gun Holders / Stiffeners

Sandwich each Foam Organizer / Gun Holder (C) in between two Plastic Stiffeners (D). Place each Foam Organizer / Gun Holder / Stiffener assembly into the channel slots in the side walls of the Humpstor (A), facing opposing directions.

Note: You may have to flex the assembly to get it into place. (Hint – Stock of gun should rest in large groove; barrel should rest in small groove.)

Velcro Straps

To secure guns in the Humpstor, loop each Velcro Strap (L) through the holes in the top of the Foam Organizer / Gun Rack (C) / Stiffener (D) assembly. Wrap the Velcro Strap around the gun, then attach the Velcro Strap to itself and make sure it is securely fastened.

Note: Proper use of Velcro Straps helps prevent guns from bouncing on rough terrain.

Center Brace

To maximize strength and stability, use the Center Brace (J). Insert each end into a hole on the top lip of the Humpstor (A) at the middle. To access cargo while using the Center Brace, lift one end out of the hole and rotate the Center Brace out of the way. Return Center Brace to hole when finished.

Locking the Humpstor

To lock Humpstor, use one or more standard padlocks. Insert lock through the latch hole.

Note: Lock only needs to go through one hole in the latch.

Note: The Middle Latch does not need to be latched to secure lid.

Note: Lid may need to be pressed down in order to close the latches when the seal is new. Once the seal has formed to the lid it should close on its own.

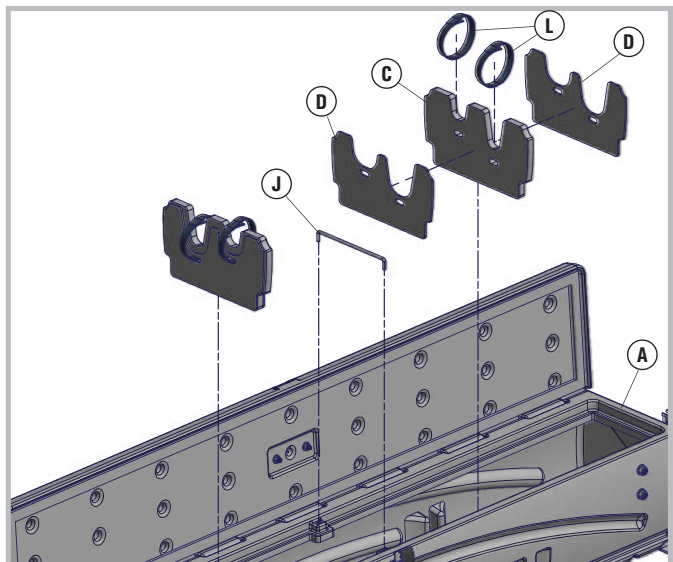

Safety Instructions:

Warning: 75 LBS CAPACITY – DO NOT EXCEED 75 POUNDS OF CARGO IN THE HUMPSTOR. CAUTION – Do not store explosives or hazardous materials in the HUMPSTOR.

Do not place loaded guns in the HUMPSTOR.

For further instructions refer to the vehicle owners manual or contact DU-HA, Inc.

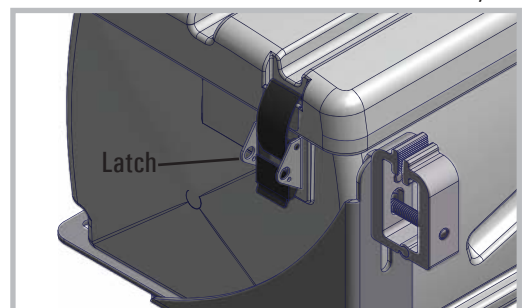

Exploded View / Parts List

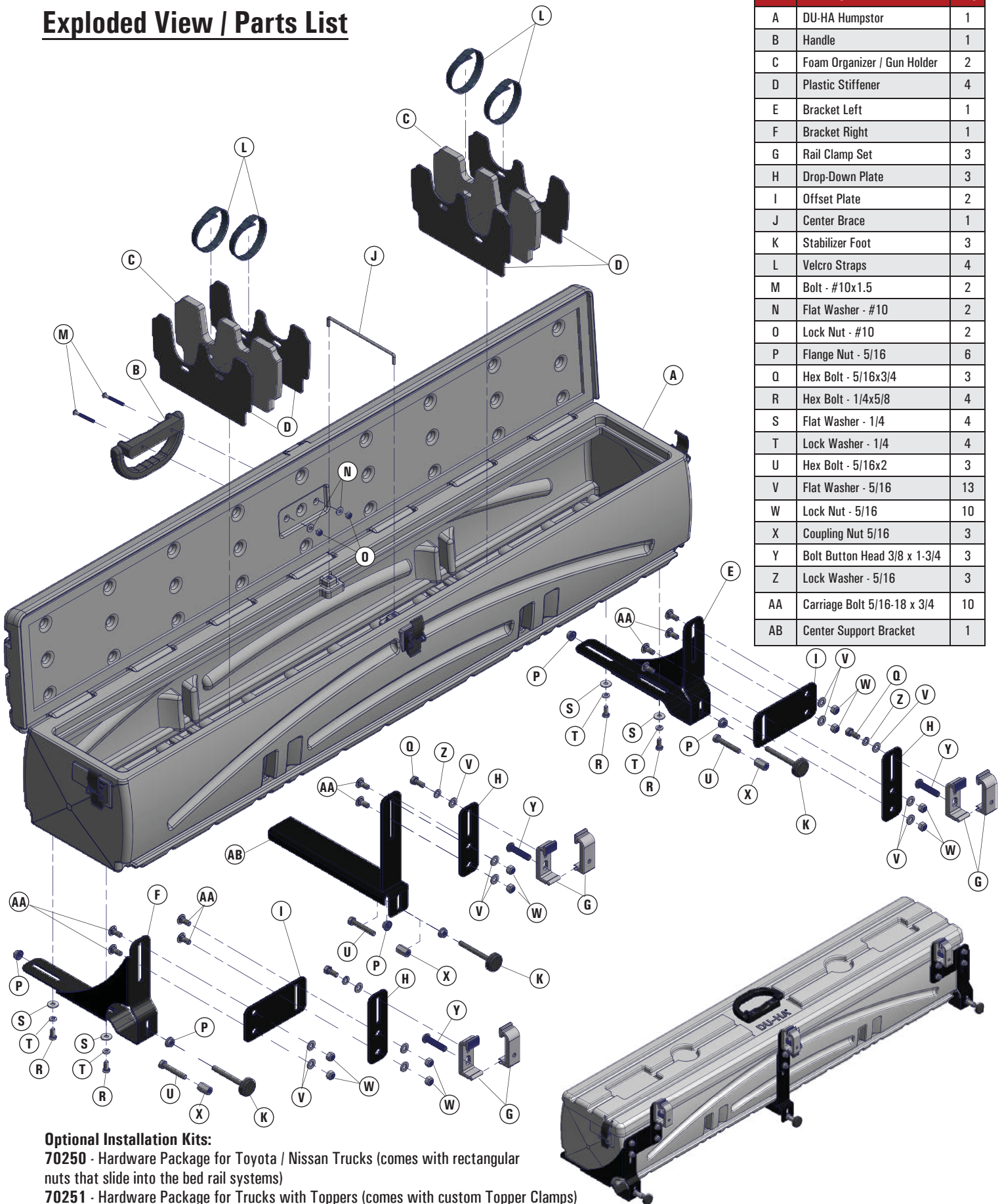

Optional Installation Kits:

70250 - Hardware Package for Toyota / Nissan Trucks (comes with rectangular nuts that slide into the bed rail systems)

70251 - Hardware Package for Trucks with Toppers (comes with custom Topper Clamps)

Note: You may have extra parts leftover, depending on your trucks installation option.